

VGA + RS232 UTP Extender 110 Type Faceplate Set

P/N: R02-EXT-RS-FP

Included in the package:

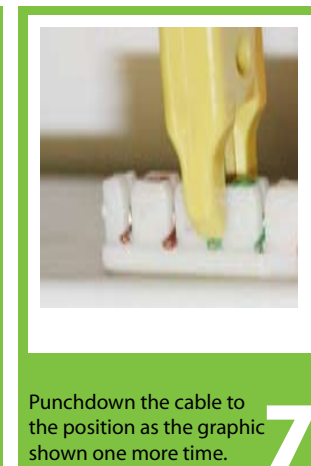
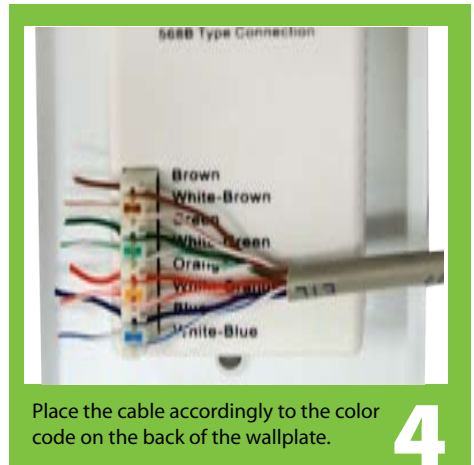
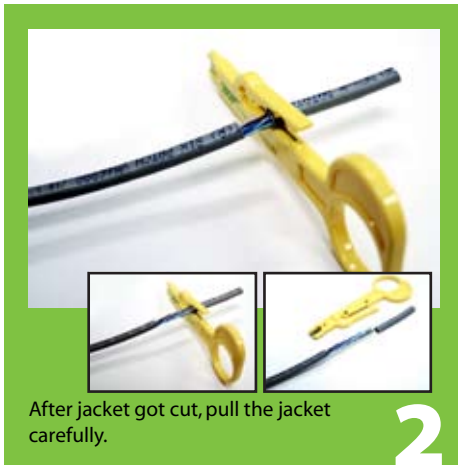
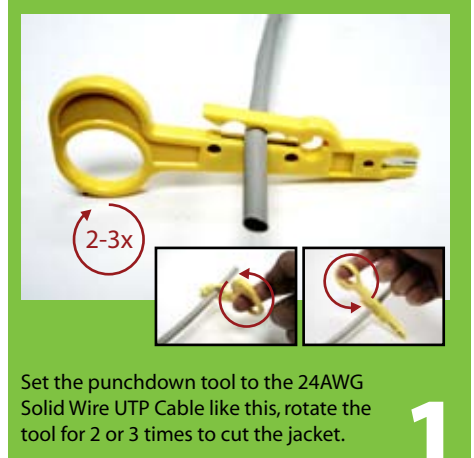

VGA + RS232 UTP Extender 110 Type Faceplate Set

P/N: R02-EXT-RS-FP

Step-by-step instruction manual:

1. Set the punchdown tool to the 24AWG Solid Wire UTP Cable (not included) and rotate the tool to cut the jacket.
2. Pull the jacket carefully.
3. Cut the unnecessary plastic.
4. Place the cable accordingly to the color code on the back of the wall-plate.
5. Punchdown the cable to the designated slot using the tool so the cable will snug properly.
6. Trim the extra cable.
7. Punchdown the cable to the position as the graphic shown one more time.
8. Snap both caps onto 110 connector.

