

SCALE 1/1

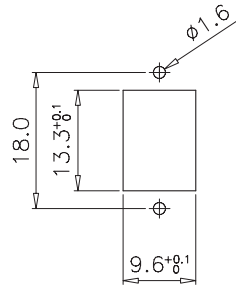

SUGGESTED PANEL CUTOUT

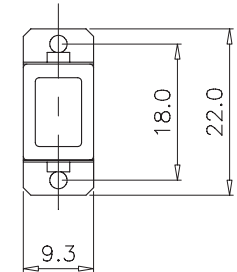
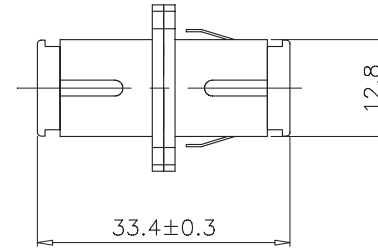
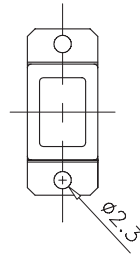

### Specification :

#### Material :

1. SC Dust Cover : PP, Black color.
2. SC Housing : PBT, UL 94V-0, Blue color.
3. Holder : PBT, UL 94V-0, Blue color.
4. Clip : STAINLESS.

#### Adaptor Type :

- a. SC to SC Simplex Type, Singlemode.
- b. Sleeve : Zirconia.
- c. Operation Temperature : -20°C to +70°C.
- d. Durability : 500 cycles.
- e. Tensile Strength : 10 kgf.
- f. Insertion Loss : <0.2 dB.



TOLERANCE			Tri-Net Technology, Inc. <a href="http://www.trinetusa.com">http://www.trinetusa.com</a>				
INCHES	M/M						
.X	.015	.30	SCALE	NONE	REV   A		
.XX	.010	.10	UNIT	MM			
.XXX	.005	.05	SHEET	1/1	DWG NO. 890-SC-SC-S		
DRAWN BY			KLi			DATE	08/14/06
CHECK BY			TITLE			SC to SC Adaptor-Simplex Type SM	
APPD BY			PART NO.			890-SC-SC-S	